



## M/V ECLIPSE



### 48-Passenger Expedition Vessel in the Galapagos Islands

Situated 1,000 kilometers (600 miles) off the coast of Ecuador, the Galapagos Islands are a living laboratory, offering visitors a unique interaction with nature. The islands are synonymous with survival and the diversity of species on earth.

The M/V Eclipse is an upscale expedition vessel that offers unparalleled levels of comfort and service. Large enough to travel the Pacific in comfort and safety, small enough to dock at remote ports and negotiate inter-island landings with agility, the M/V Eclipse features outstanding open-air spaces, comfortable cabins, and spectacular al fresco dining.

#### ACCOMMODATION

Our 26 spacious staterooms accommodate up to 48 passengers – just half the number usually found on a ship this size. This means that passengers can enjoy the generous accommodation of a larger vessel, while preserving the atmosphere and exclusivity of a smaller yacht.

The Eclipse offers accommodation in five cabin categories, all stylishly decorated and equipped with private facilities, air conditioning, and ocean-view windows or portholes.

Two Deluxe Staterooms have an extra bed for triple occupancy and two Staterooms on each cabin deck have interconnecting doors to accommodate families.

#### FACILITIES

In addition to the chic indoor dining room, the Eclipse features an al fresco dining area, where guests can savor a scrumptious meal with the islands' stunning scenery as a backdrop. The lounge provides a relaxed atmosphere for the nightly

briefings and lectures on board, and the library is a quiet place to catch up on some reading. One of the most popular areas is the sun deck, ideal for wildlife viewing, soaking in the Jacuzzi or relaxing in the comfortable sun loungers. The ship also has an infirmary, with a doctor on board at all times.

#### UNRIVALLED ITINERARIES

All our itineraries operate from Saturday to Saturday, and they are designed to showcase the very best of the Galapagos Islands.

Our Española route includes jaw-dropping Galapagos scenery at Moreno Point on Isabela Island, as well as Española Island, home to the unique waved albatross and other breathtaking wildlife and landscapes. This route can also be taken as a 5-night cruise, from Saturday to Thursday, which includes one full day in the western region of the islands.

Our 7-night Genovesa itinerary takes in the northern region of the archipelago, with visits to Isabela and Fernandina Islands, renowned



for their unique wildlife and exceptional snorkeling. Genovesa Island is home to some of the most extraordinary birdlife you will ever see, and the view from the top of Bartolomé Island is emblematic of the Galapagos.

### ISLAND EXCURSIONS

The M/V Eclipse anchors off-shore at two visitor sites per day. Guests are divided into groups of a maximum of twelve people, then ferried to landing points in motorized dinghies. On the islands, visitors follow marked trails, walking at a leisurely pace, with the guide explaining the unusual sights. 3 or 4 hours are spent at each site, allowing plenty of time to explore and to photograph the abundant wildlife. Afterwards, there is often an opportunity to swim, snorkel or kayak before returning to the Eclipse.

### RESPONSIBLE TRAVEL

The M/V Eclipse operates under two equally important guidelines: to ensure the comfort and safety of our passengers at all times, and to protect the integrity of the fragile Galapagos environment. The M/V Eclipse is certified within the Rainforest Alliance "Smart Voyager" program.

### COMMITMENT TO CHILDREN

Taking children to the Galapagos Islands is an immensely rewarding experience. For this reason, the M/V Eclipse has developed selected family departures that combine discovery and entertainment for the whole family.

On scheduled family departures, a Child Coordinator is assigned to educate and entertain your children. This will allow you to enjoy the

cruise at your own pace, in the knowledge that your children are in safe hands, making their own discoveries about the history of evolution and the unique species of the islands. There are no fixed programs. Each family departure is operated according to the children's preferences and group dynamics.

### BALTRA AIRPORT VIP LOUNGE

M/V Eclipse passengers leaving the Galapagos Islands are welcome to use Baltra Airport's VIP Lounge before their flight back to the mainland.

### TECHNICAL INFORMATION

Length: 210 ft / 64 m  
Draft: 11 ft / 3.2 m  
Gross Tonnage: 1610  
Cruising Speed: 11 knots  
Life Jackets: In each cabin  
Lifeboats: 6

### GENERAL INFORMATION

**On-board payments:**  
The bar and boutique bill is paid at the end of the cruise in US Dollars. We accept Visa, MasterCard or American Express. Passengers do not need to carry cash on board.

**Wi-Fi:**  
Passengers can access the Wi-Fi network in the social areas by purchasing one of the Internet plans on board.

**Electricity:**  
All cabins have both 110 & 220 volt electrical outlets.

**Dress Code:**  
We pride ourselves on an informal "non-cruise" atmosphere aboard the Eclipse. While you might like to change out of your beach clothes for dinner, you won't need a wardrobe any dressier than smart-casual.

**Smoking policy:**  
Smoking is only permitted in the al fresco dining area or on the sun deck.







Al Fresco Dining



Main Lounge



Library



Sun Deck



Reception



Boutique

## Deck Plan M/V Eclipse

- 17-20 / Deluxe Stateroom
- 21-28 / Superior Stateroom
- 9-11-15 / Standard Stateroom
- 3-8 +10 / Stateroom
- 1-2 / Single Stateroom
- Inter-connected Cabins
- Social Areas
- Restricted Areas

Sun Deck  
Boat Deck  
Weather Deck  
Main Deck

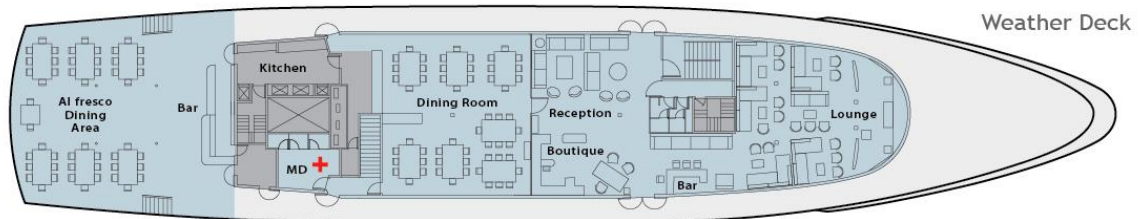
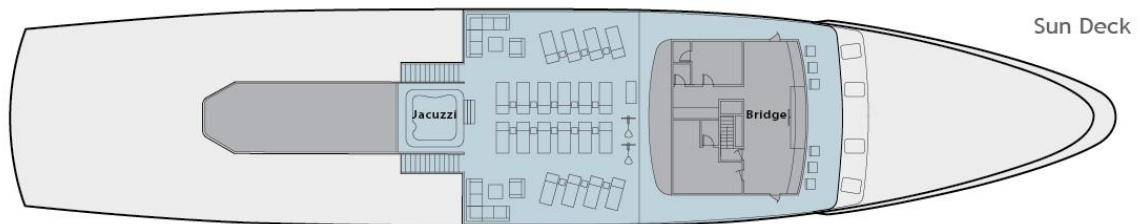
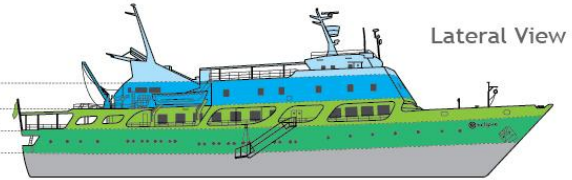

**CABIN 1**  
Area: 110 sq. ft.



**CABIN 6**  
Area: 170 sq. ft.

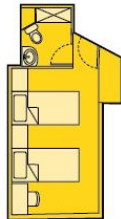

**CABIN 11**  
Area: 170 sq. ft.

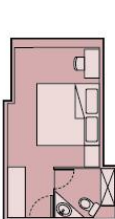

**CABIN 27**  
Area: 170 sq. ft.

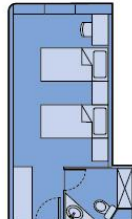

**CABIN 18**  
Area: 210 sq. ft.

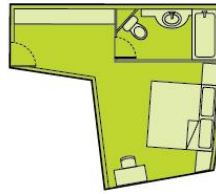

**Cabin layout:**

- 4 Deluxe Staterooms on the Boat Deck
- 8 Superior Staterooms with picture windows on the Boat Deck
- 5 Standard Staterooms with portholes on the Main Deck
- 7 Staterooms with portholes on the Main Deck
- 2 Single Staterooms with portholes on the Main Deck

\* Cabin areas are approximate measurements.